

# Technical data sheet



## Product features

### Pasta cooker electric 16 + 16 l without cabinet 400 V

<b>Model</b>	<b>SAP Code</b>	00110123
--------------	-----------------	----------



- Basin volume [l]: 16
- Water inlet: mechanical tap
- Drain type: On the front panel
- Drain: Yes
- Safety drain: Yes
- Material: Stainless steel
- Protection of controls: IPX4
- Maximum device temperature [°C]: 110

<b>SAP Code</b>	00110123	<b>Loading</b>	400 V / 3N - 50 Hz
<b>Net Width [mm]</b>	800	<b>Basin volume [l]</b>	16
<b>Net Depth [mm]</b>	700	<b>Width of internal part [mm]</b>	308
<b>Net Height [mm]</b>	330	<b>Depth of internal part [mm]</b>	336
<b>Net Weight [kg]</b>	32.00	<b>Height of internal part [mm]</b>	213
<b>Power electric [kW]</b>	9.000		

# Technical data sheet



Technical drawing

Pasta cooker electric 16 + 16 l without cabinet 400 V

Model

SAP Code

00110123

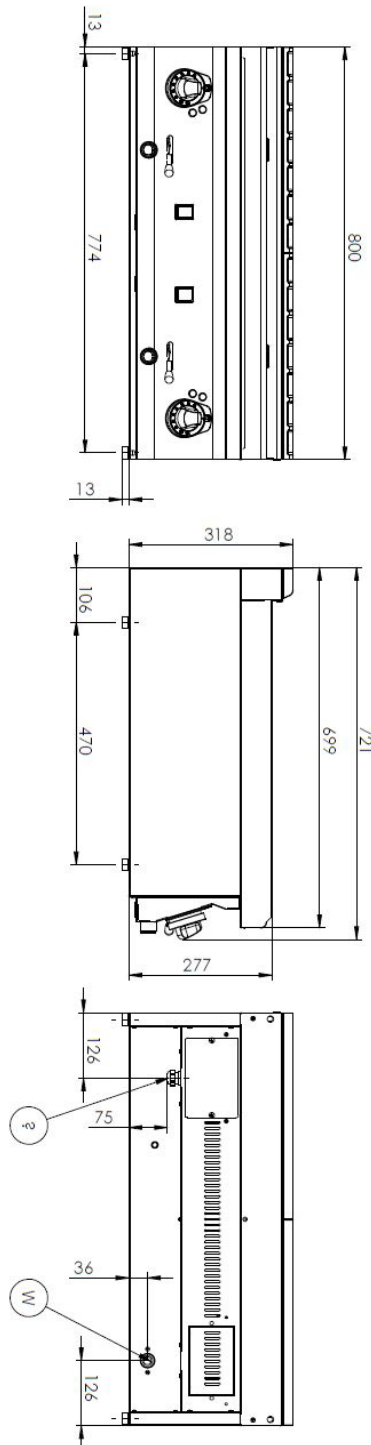

# Technical data sheet



## Product benefits

### Pasta cooker electric 16 + 16 l without cabinet 400 V

Model

SAP Code

00110123

1

#### All-stainless steel bathtub

long life  
resistance of AISI 304 stainless steel material  
the material does not cut

- savings on service interventions
- easier and faster operation

2

#### Degree of protection of the control elements IPX4

maintenance-free system  
resistance to splash water  
long life

- savings on service interventions
- easy cleaning and maintenance of equipment

3

#### Drain valve ¾" in the front part of the device with a safety lock against self-draining

outlet of the bath into the prepared container

- easy and safe handling

# Technical data sheet



## Technical parameters

### Pasta cooker electric 16 + 16 l without cabinet 400 V

<b>Model</b>	<b>SAP Code</b>	00110123
--------------	-----------------	----------

**1. SAP Code:**

00110123

**2. Net Width [mm]:**

800

**3. Net Depth [mm]:**

700

**4. Net Height [mm]:**

330

**5. Net Weight [kg]:**

32.00

**6. Gross Width [mm]:**

840

**7. Gross depth [mm]:**

800

**8. Gross Height [mm]:**

390

**9. Gross Weight [kg]:**

43.50

**10. Device type:**

Electric unit

**11. Construction type of device:**

Table top

**12. Power electric [kW]:**

9.000

**13. Loading:**

400 V / 3N - 50 Hz

**14. Protection of controls:**

IPX4

**15. Material:**

Stainless steel

**16. Indicators:**

operation and warm-up

**17. Worktop type:**

Molded - comfortable cleaning maintenance

**18. Worktop material:**

AISI 304

**19. Worktop Thickness [mm]:**

1.20

**20. Basin volume [l]:**

16

**21. Basin dimensions [mm x mm x mm]:**

2x 308 x 336 x 213

**22. Maximum device temperature [°C]:**

110

**23. Minimum device temperature [°C]:**

30

**24. Service accessibility:**

Trough the frontal panel

**25. Safety thermostat:**

Yes

**26. Safety thermostat up to x ° C:**

130

**27. Adjustable feet:**

Yes

**28. Heating element material:**

Incoloy

# Technical data sheet



Technical parameters

## Pasta cooker electric 16 + 16 l without cabinet 400 V

**Model**

**SAP Code**

00110123

**29. False bottom:**

Yes

**34. Drain:**

Yes

**30. Number of basins:**

2

**35. Safety drain:**

Yes

**31. Basin material:**

AISI 316 - Stainless steel highly resistant to salt water

**36. Width of internal part [mm]:**

308

**32. Water inlet:**

mechanical tap

**37. Depth of internal part [mm]:**

336

**33. Drain type:**

On the front panel

**38. Height of internal part [mm]:**

213